



CHARACTERISTICS

CROXON POL is a polyurethane foam panel with a rubber elastomeric membrane, both recycled, high density, attached to one side. Formed so that the set provides an excellent airborne sound insulation to the originals, especially at low and medium frequencies.

CROXON POL is a product bivalent very effective with applications both control airborne noise as impact noise, which allows to focus above one product two different applications, because the impedance generated by their composition.

SPECIFICATIONS

Nature	
Absorbent	Recycled polyurethane foam (10 mm thickness).
Sheet	Recycled rubber (10 mm thickness).
Sound reduction index	50,5 dB(A).
Impact noise improvement	ΔL_w 42 (dB).
Elongation at break	38 %.
Compressive strength	8 kpa.
Thermal resistance	1.05° C m ² K/W.
Working temperature	- 40 to + 110° C.
Recyclability	100 %.
Overall weight	9 kg/m ² .
Appearance	20 x 1000 x 1000 mm sheets.

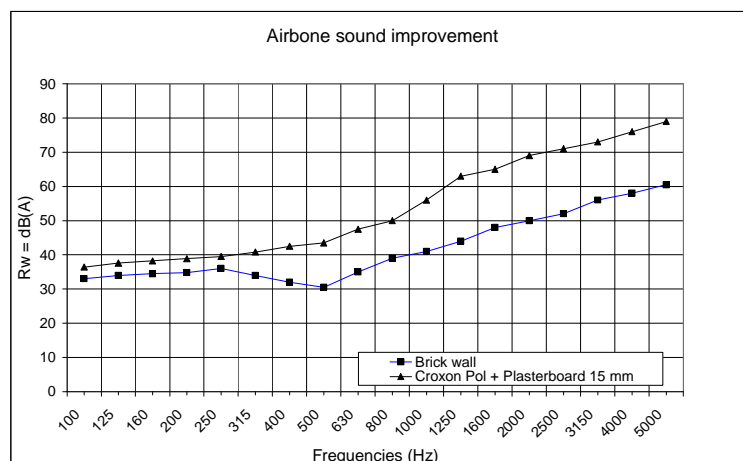

Airborne sound improvement of a brick wall of 10 mm thick, Croxon Pol 20 and a plasterboard of 15 mm. $R_w = 50.5$ dB(A).

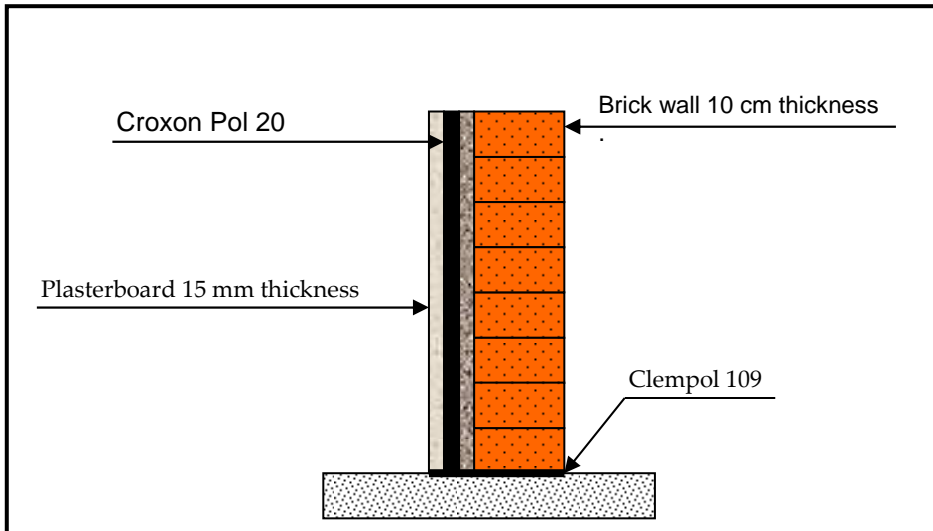

Croxon Pol detail installation

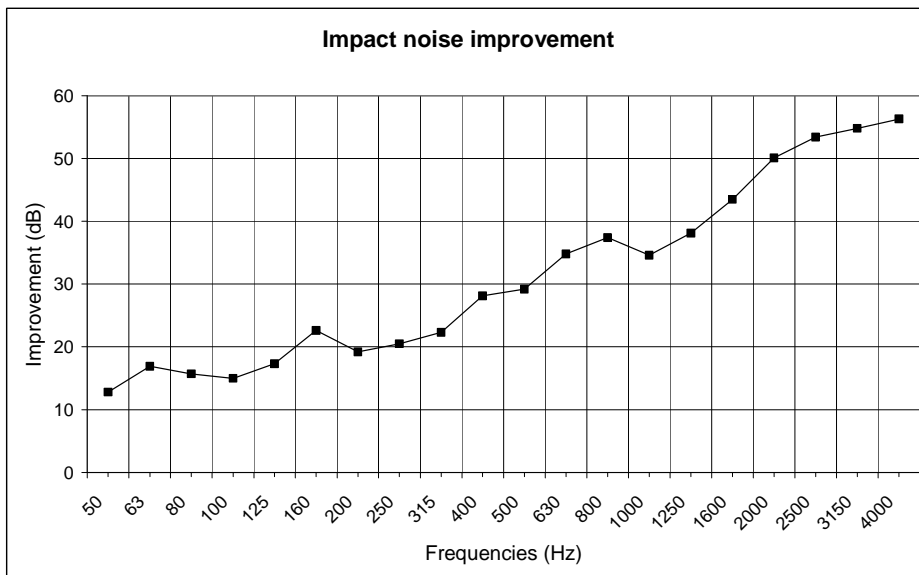

Impact noise improvement under a concrete slab 5 cm thickness ($L_w = 42$ dB).

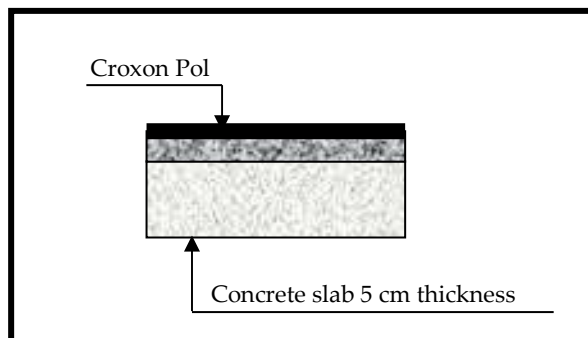

Installation details CROXON POL under slab

PROPERTIES

CROXON POL has the following advantages:

- High impact noise and airborne soundproofing.
- Easy installation.
- No asphalt or bitumen membrane.
- The membrane does not crystallize or stiffens.
- Both components are recycled and recyclable.

APPLICATIONS

CROXON POL is used to:

- Soundproofing ceilings, walls floors
- Soundproofing impact and airborne
- Acoustic isolation booth, machine rooms, air ducts, etc.
- Used in both new buildings and refurbishment of industries, cinemas, theatres, sports, clubs, bars, restaurants, hotels, shopping centres, etc.

HOW TO USE

Walls

The substrate must be regularized, smooth and dry. Apply a coat of Crosone 325 on the support. Then, addressing the panel **CROXON POL** by the absorbing surface, pressing lightly.

CROXON POL panels be placed at head, juxtaposed next to each other. Subsequently, its must be sealed with **CROSONE 325** to avoid the sound migration.

Floors

The substrate must be clean and dry. **CROXON POL** panels will be installed at head, side by side, with the absorbent face down.

Next, it must be installed the **CLEMPOL 109**, a baseboard band and a polyetilene film to be traced over ti to ensure the soundproofing.

Install wire mesh and pouring the concrete for making the slab.



This products considers all aspect of reducing environmental impact through Eco-Design, using the methologic based on EDECON Proyect funded by the European Commission.

Information in this document and otherwise supplied to users is based on our general experiences and is given in good faith but, because of particular factors which are outside our knowledge and control and affect the use of products, no warranty is given or implied with respect to such information. Specifications are subject to change without notice.

CROXON, S. L.

Polig. Ind. Majaravique, 27 B
41309 La Rinconada (Sevilla)
Telf.: +34 954 904 225
Fax: +34 954 906 676
E-mail: croxon@croxon.es
Web: www.croxon.es